



REGIONAL DISTRICT OF
NORTH OKANAGAN

ELECTORAL AREA F
OFFICIAL COMMUNITY PLAN

Schedule D - Detail 1
Fall Creek Slide
Development Permit Area

To Accompany Official Community
Plan Bylaw No. 2702, 2016

LEGEND

Hazard Rating

- 0 - Low
- 1
- 2 - Medium
- 3
- 4 - High

- Fall Creek Slide Development Permit Area Boundary and Limit of Data from Source
- Map Sheet Boundaries

T.P. 18 R7 W6

34

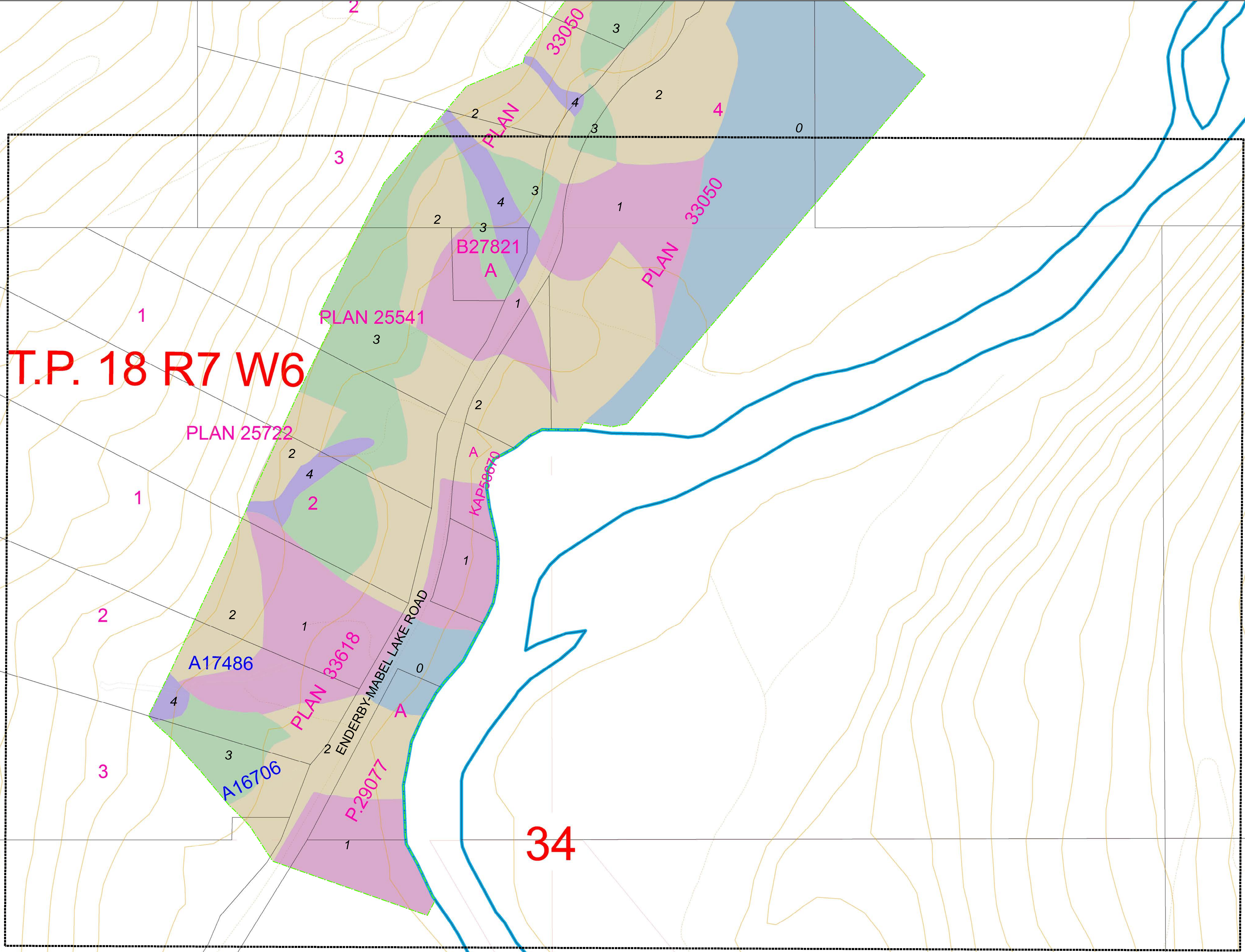

Schedule "D" to accompany Regional District of North Okanagan "Electoral Area "F" Official Community Plan Bylaw No. 2702, 2016"

I hereby certify the foregoing to be a true and correct copy of Schedule "D" attached to and forming part of Bylaw No. 2702, 2016 cited as "Electoral Area "F" Official Community Plan Bylaw No. 2702, 2016" as ADOPTED by The Board of Directors on the ___ day of _____, 2016.

Dated at Coldstream, BC this ___ day of _____, 2016.

Corporate Officer _____

Data Source:
Debris Flow Hazard Assessment - Fall Creek Slide Area, report to Provincial Emergency Program, Ministry of Solicitor General, Thurber Engineering Ltd. November 1990, File 15-52-0

