

FOR CONTINUATION SEE DRAWING GVW-306

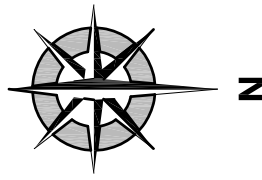

LEGEND:

- Legend:
- Sanitary System
 - Water Main
 - Valve
 - Private Hydrant
 - Fire Hydrant
 - Fire Stand Pipe
 - Intake
 - Pump

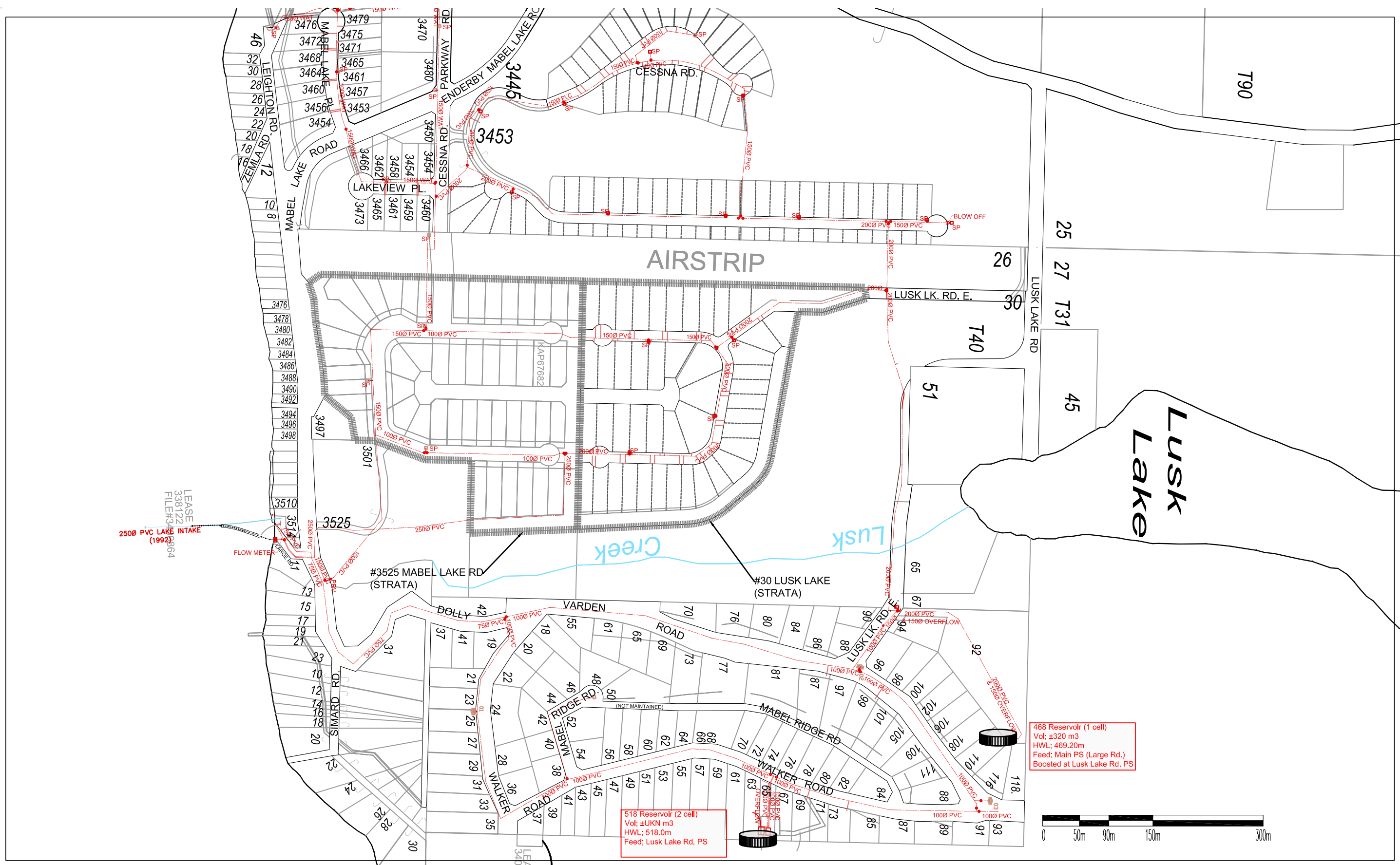

468 Reservoir (1 cell)
 Vol: ±320 m3
 HWL: 469.20m
 Feed: Main PS (Large Rd.)
 Boosted at Lusk Lake Rd. PS

518 Reservoir (2 cell)
 Vol: ±UKN m3
 HWL: 518.0m
 Feed: Lusk Lake Rd. PS



5				
4				
3				
2				
1	Jan14,2011	LG	ISSUED FOR WEB SITE PUBLISHING	LG
No.	Date	By	Revision	CHK'd

Drawn: LUG
 Design: N/A
 Approved: N/A
 Date: APRIL,2010
 Scale: 1:2500

**REGIONAL DISTRICT OF
 NORTH OKANAGAN**

**Mabel Lake
 Water System Overview**

**DRAWING NUMBER
 GVW-305**

Z:\CADD\ReferendeBaseDrawings\SmallWaterSystemMapping\2011_RDNO_Small_Utility_Base.dwg, 1/14/2011 11:30:15 AM, Adobe PDF, 11 x 17, 1:50, 9212