

Bobbie Burns Mountain

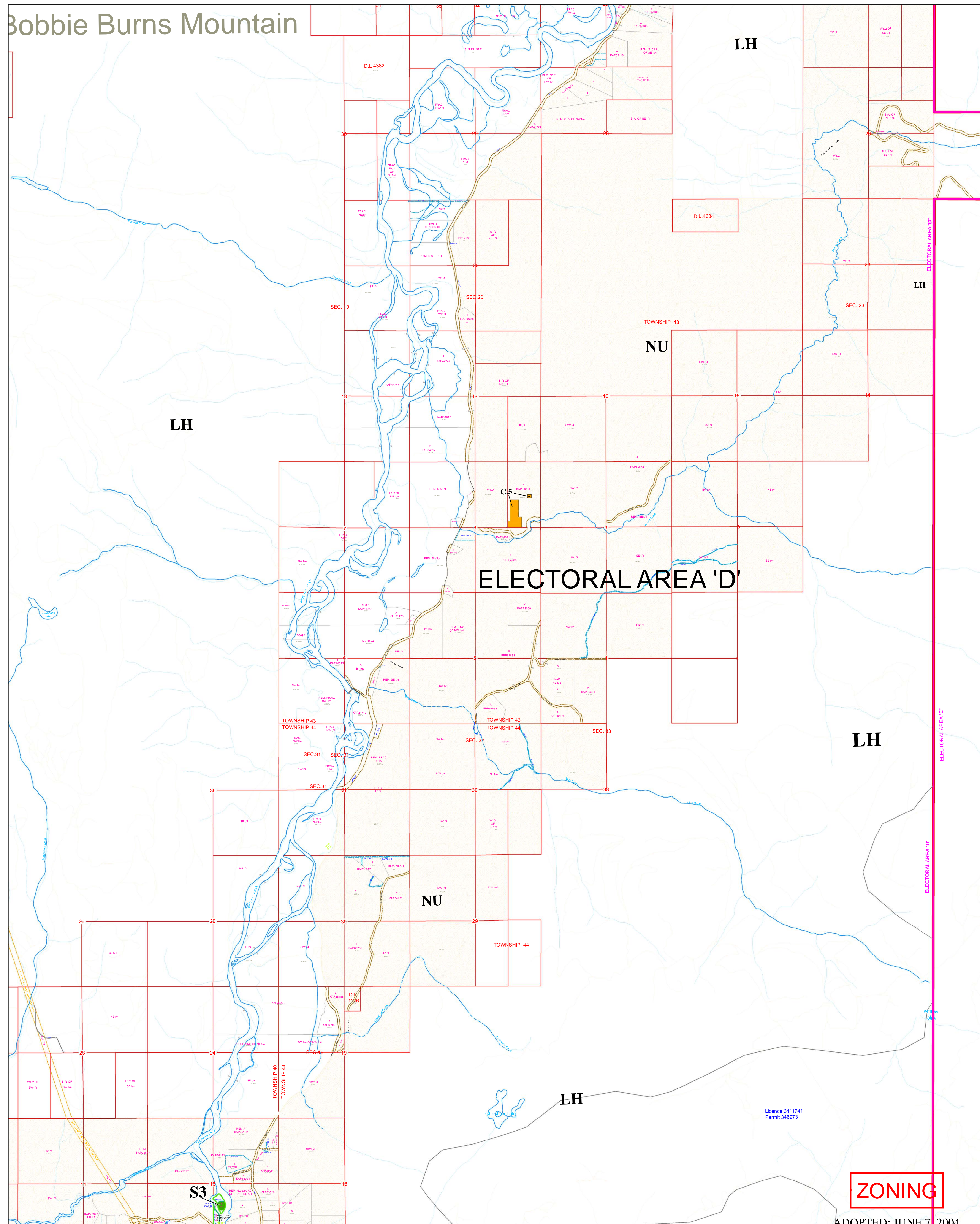

ZONING

ADOPTED: JUNE 7, 2004

<p>REGIONAL DISTRICT OF NORTH OKANAGAN</p>	LEGEND:		C.1 General Commercial	L.1 Light Industrial	R.1 Residential Seasonal Single Family	S.H Small Holding	CD.1 Trails at Enderby Comprehensive Development Zone
	C.2 Highway and Tourist Commercial	L.2 General Industrial	R.2 Residential Two Family	C.R Country Residential	N.U Non-Urban	CD.2 Fairhaven Ministries Association Comprehensive Development Zone	CD.2 Fairhaven Ministries Association Comprehensive Development Zone
	C.3 Neighbourhood Commercial	L.3 Industrial Park	R.3 Residential Apartment and Multi-Family	N.LH Non-Urban Large Holding	S.1 Spray Irrigation	CD.3 Mabel Lake Golf and Country Club Comprehensive Development Zone	CD.3 Mabel Lake Golf and Country Club Comprehensive Development Zone
	C.4 Recreation Commercial	L.4 Agricultural Industrial	R.4 Residential Manufactured Home Subdivision	S.2 Residential Attendance Program	CD.4 Seasonal Single Family Recreation Comprehensive Development Zone	CD.4 Seasonal Single Family Recreation Comprehensive Development Zone	CD.4 Seasonal Single Family Recreation Comprehensive Development Zone
	C.5 Service Commercial	L.5 High-Tech Business	R.5 Residential Manufactured Home Community	S.3 Community Park and Public Use	LUC Land Use Contract	LUC Land Use Contract	LUC Land Use Contract
	C.6 Rec. Vehicle Campground/Resort Commercial		R.6 Residential Seasonal Single Family		RDNO RDNO Jurisdictions Boundary	RDNO RDNO Jurisdictions Boundary	RDNO RDNO Jurisdictions Boundary

Last Updated: June 2004

Schedule "A" to accompany Regional District of North Okanagan "Zoning Bylaw No. 1888, 2003"

I hereby certify this to be a true and correct copy of Schedule "A" attached to and forming part of the Regional District of North Okanagan "Zoning Bylaw No. 1888, 2003".

Corporate Officer

This document is a composite legal drawing. Several information sources have been used to create this drawing including the B.C. Land Titles Office, The Regional District, local Municipal Governments and a number of Provincial ministries. As such the Regional District of North Okanagan assumes no responsibility for the accuracy or completeness of this drawing. The original data sources should be contacted to verify information as needed.

Path: Z:\Project Drawings\ZONING\BL1888\03 MAPS AREAS_DE\Portrait_DE4_Zoning_D_E.mxd

REGIONAL DISTRICT OF NORTH OKANAGAN

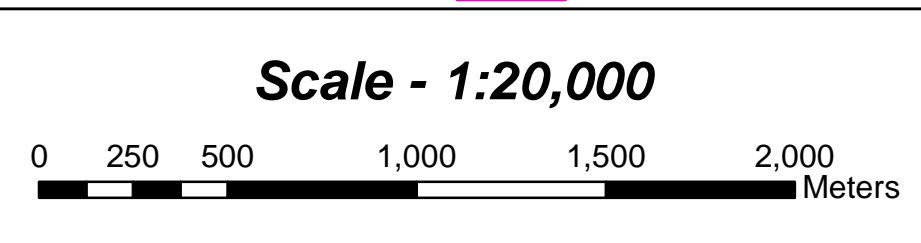

Drawing Location:
**AREA D- MAP SHEET DE.4
MABEL LAKE AREA**