

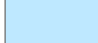

Legend

-  Affected Properties (Non-Potable Water Services Only)
-  Unaffected Properties

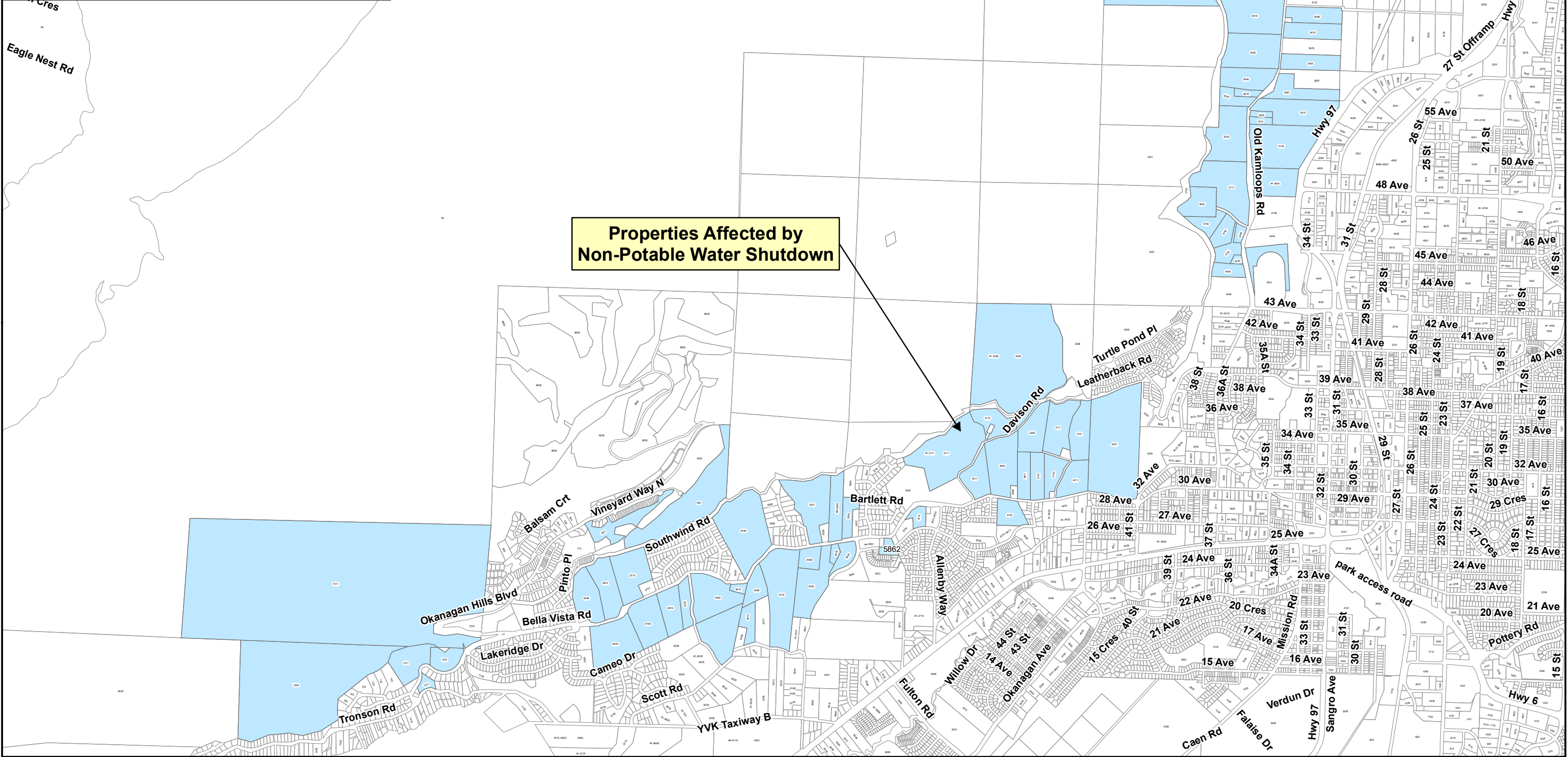

This map was compiled by RDNO, using data believed to be accurate; however, a margin of error is inherent in all maps. This product is distributed without warranties of any kind, either express or implied, including but not limited to warranties of sustainability or particular purpose or use.

Properties Affected by Non-Potable Water Shutdown

Plot Date: Feb 15, 2023

Scale: 1:25,000



Plot Size: 17" x 11"



REGIONAL DISTRICT NORTH OKANAGAN

