

REGIONAL DISTRICT OF
NORTH OKANAGAN

ELECTORAL AREA F
OFFICIAL COMMUNITY PLAN

Schedule C - Detail 5
(Mabel Lake)
General Land Use

To Accompany Official Community
Plan Bylaw No. 2702, 2016

LEGEND

OCP Designations

- Agricultural
- Commercial
- Future Commercial
- Country Residential
- Industrial
- Large Holding
- Non Urban
- Parks
- Future Park (general location)
- Residential
- Small Holding
- Transportation Corridor
- Comprehensive Resort Development
- Public and Assembly
- School
- Map Sheet Boundaries
- Future Road
- ALR
- First Nation Reserves
- RDNO Jurisdictions Boundary

BYLAW AMENDMENTS:
Consolidated with amendments for convenience only.

Schedule "C" to accompany Regional District of North Okanagan
"Electoral Area "F" Official Community Plan Bylaw No.2702,2016"

I hereby certify the foregoing to be a true and correct copy of
Schedule "C" attached to and forming part of the Bylaw No.2702,
2016 cited as "Electoral Area "F" Official Community Plan Bylaw
No.2702, 2016" as ADOPTED by the Board of Directors on the
_day of __, 2016.

Date at Coldstream, BC this _day of __, 2016.

Cooperate Officer

Note:
The Agricultural Land Use Designation is generally consistent with ALR
boundaries. As this is a representation of ALR designations, refer to the
maps retained by the Agricultural Land Commission for exact boundaries.

Designations within the area of Schedule B1 / B2/ B3 / B4 / B5 / B6 shown
on Schedule B are for information only. Official designation for the areas of
Schedule B1 / B2/ B3 / B4 / B5 / B6 are shown on those schedules.

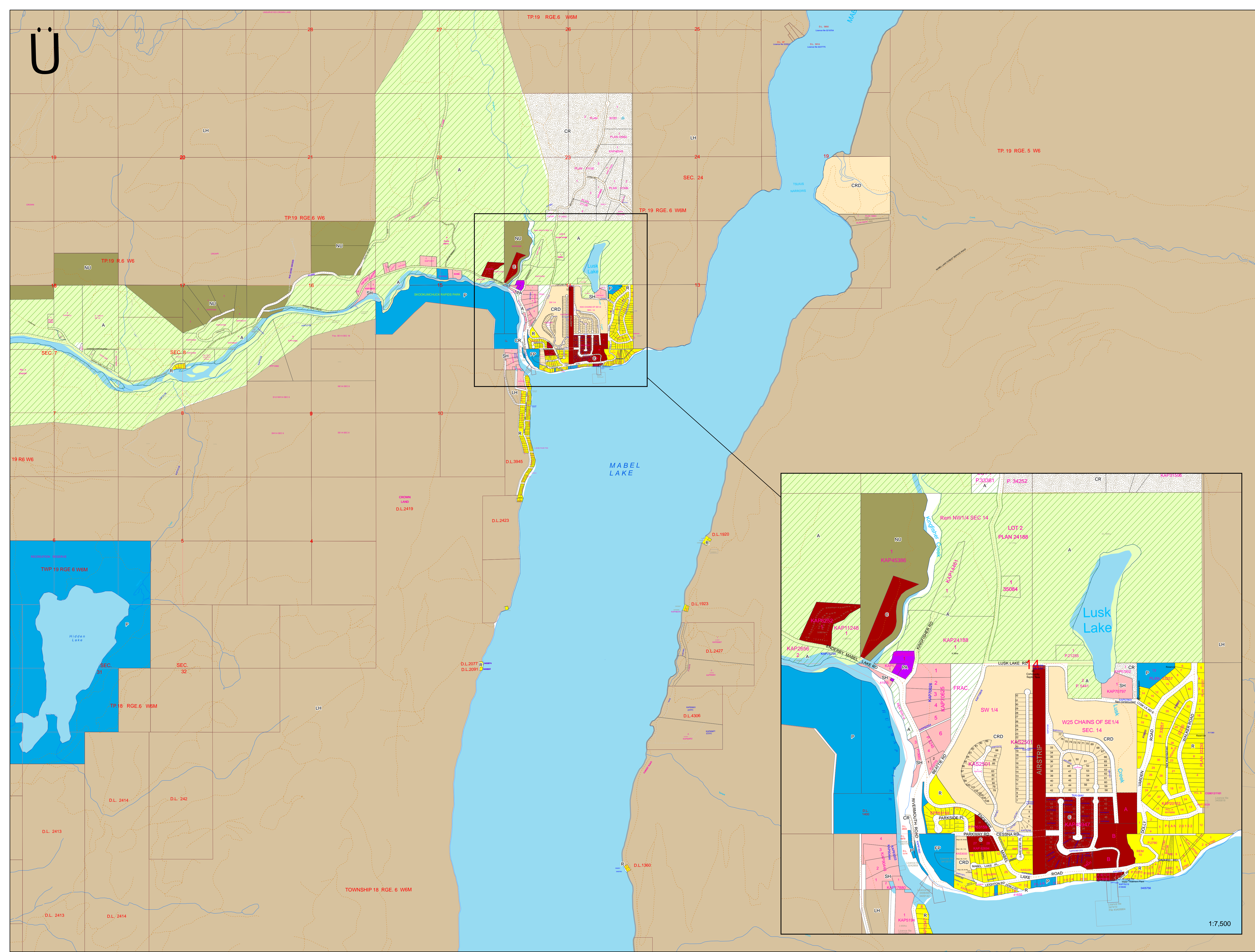
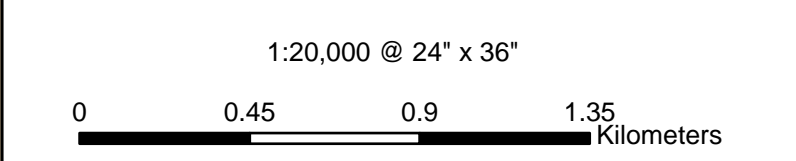

Ü