

**REGIONAL DISTRICT OF NORTH OKANAGAN
BYLAW NO. 586, 1984**

CONSOLIDATED FOR CONVENIENCE

This document is an office consolidation of the above-noted Bylaw and includes the amendments listed below. This Bylaw has been consolidated for convenience and is intended for information and reference purposes only. This document is not the official version of the Bylaw. Be advised that plans, pictures, other graphics or text in the official version may be missing or altered in this consolidated version. Where accuracy is critical, please contact the Corporate Services Department at the Regional District of North Okanagan.

AMENDMENTS

Bylaw No.	Adopted	Amendment
640, 1985	May 15, 1985	– Replaced Schedule “A”

REGIONAL DISTRICT OF NORTH OKANAGAN

BY-LAW NO. 586

A By-law to establish a specified area within Electoral Area "F" of the Regional District of North Okanagan for the purpose of providing Street Lighting

WHEREAS the Regional Board of the Regional District of North Okanagan has been requested by petition to establish a specified area for the purpose of providing street lighting to the community of Grindrod;

AND WHEREAS by Supplementary Letters Patent dated the 15th day of May, 1975, the Regional Board was authorized to establish, maintain, and operate a street lighting service and to define areas of an electoral area to be a street lighting service unit;

NOW THEREFORE the Regional Board of the Regional District of North Okanagan in open meeting assembled enacts as follows:

1. The Regional Board is hereby empowered and authorized:
 - (1) to establish in Electoral Area "F" a specified area known as the "Grindrod Street Lighting Service Unit" and such area shall be comprised of that tract of land described on Schedule "A" attached hereto and forming part of this By-law;
 - (2) to undertake and carry out or cause to be carried out and provide street lighting in and for the said street lighting service unit and to do all things necessary in connection therewith.
2. The entire cost of providing street lighting shall be borne by the owners of land in the said street lighting service unit and a sum sufficient therefore shall be levied and raised in the manner prescribed in the Municipal Act in each year commencing with the year 1984, for such period of time as necessary, on all lands and improvements on the basis of assessment as fixed for taxation for school purposes, excluding property that is taxable for school purposes only by special Act within the said street lighting service unit.
3. The street lighting service unit established by this by-law may be merged with any other street lighting service unit, whether contiguous or not, in the manner provided in Section 677(3) of the Municipal Act.
4. This By-law may be cited as the "Grindrod Street Lighting Service Unit By-law No. 586, 1984".

READ A FIRST TIME this 11th day of April, 1984.

READ A SECOND TIME this 11th day of April, 1984.

READ A THIRD TIME this 11th day of April, 1984.

Approved by the Inspector of Municipalities this 8 day of June, 1984.

RECONSIDERED, FINALLY PASSED, AND ADOPTED this 13 day of June, 1984.



CHAIRMAN



SECRETARY-TREASURER

"I hereby certify the foregoing to be a true and correct copy of By-law No. 586, being 'Grindrod Street Lighting Service Unit By-law No. 586, 1984' as read a third time by the Regional Board of the Regional District of North Okanagan on the 11th day of April, 1984.



SECRETARY-TREASURER

REGIONAL DISTRICT OF NORTH OKANAGAN

SCHEDULE "B"

"Grindrod Street Lighting Service Unit Amendment By-law No. 640, 1985"

Specified Area

Commencing at the most northerly corner of Lot 1, Block 2, of Lot 526, Kamloops Division of Yale District, Registered Plan 592 on file in the Land Title Office, Kamloops; thence northeasterly in a straight line to the most southerly corner of that part of Lot 526 shown outlined in red on Registered Plan B789; thence northeasterly, northwesterly and southwesterly along the southeasterly, northeasterly and northwesterly boundaries of said part of Lot 526 shown outlined in red on Plan B789 to the most westerly corner thereof; thence southwesterly in a straight line to the most northerly corner of Lot 1, Block 1 of Lot 526, Plan 592; thence southwesterly along the northwesterly boundaries of Lots 1 to 6, inclusive, of Block 1 of Lot 526, Plan 592 to the most westerly corner of said Lot 6, Plan 592; thence northwesterly in a straight line to the most easterly corner of Block 25 of Lot 526, Plan 592; thence northwesterly, southwesterly and southeasterly along the north-easterly, northwesterly and southwesterly boundaries of said Block 25, Plan 592 to the most southerly corner thereof; thence southeasterly in a straight line to the most northerly corner of Lot 22, Block 1 of Lot 526, Plan 592; thence southwesterly along the northwesterly boundaries of Lots 22 to 27, inclusive, of Block 1 of Lot 526, Plan 592 to the most westerly corner of said Lot 27, Plan 592; thence southeasterly along the southwesterly boundaries of Blocks 1, 5 and 6 of Lot 526, Plan 592 and crossing all intervening roads and lanes thereof, to the most southerly corner of said Block 6, Plan 592; thence northeasterly along the southeasterly boundary of said Block 6, Lot 526, Plan 592, to the most easterly corner thereof; thence southeasterly in a straight line to the most northerly corner of Block 13, Lot 526, Plan 592; thence southeasterly along the northeasterly boundaries of Blocks 13 and 14, Lot 526, Plan 592, and crossing all intervening roads and lanes thereof to the most easterly corner of said Block 14; thence southeasterly along the southeasterly prolongation of the northeasterly boundary of Block 14 of Lot 526, Plan 592 to the point of intersection with the natural highwater mark of Shuswap River on the left bank thereof; thence in a general northerly direction along said highwater mark of Shuswap River to the point of intersection with the southeasterly prolongation of the northeasterly boundary of Lot A, Block 10, of Lot 526, Registered Plan 21990; thence northwesterly along said prolongation and continuing northwesterly, southwesterly and northwesterly along the northeasterly, northwesterly and northeasterly boundaries of Lot A, Block 10, of Lot 526, Plan 21990 to the most northerly corner thereof; thence northwesterly in a straight line to the most easterly corner of Lot 12, Block 9, of Lot 526, Plan 592; thence northwesterly along the northeasterly boundaries of Blocks 9 and 2 of Lot 526, Plan 592 and crossing all intervening roads and lanes thereof to the aforesaid most northerly corner of Lot 1, Block 2, of Lot 526, Plan 592, being the point of commencement.

43 GRINDROD

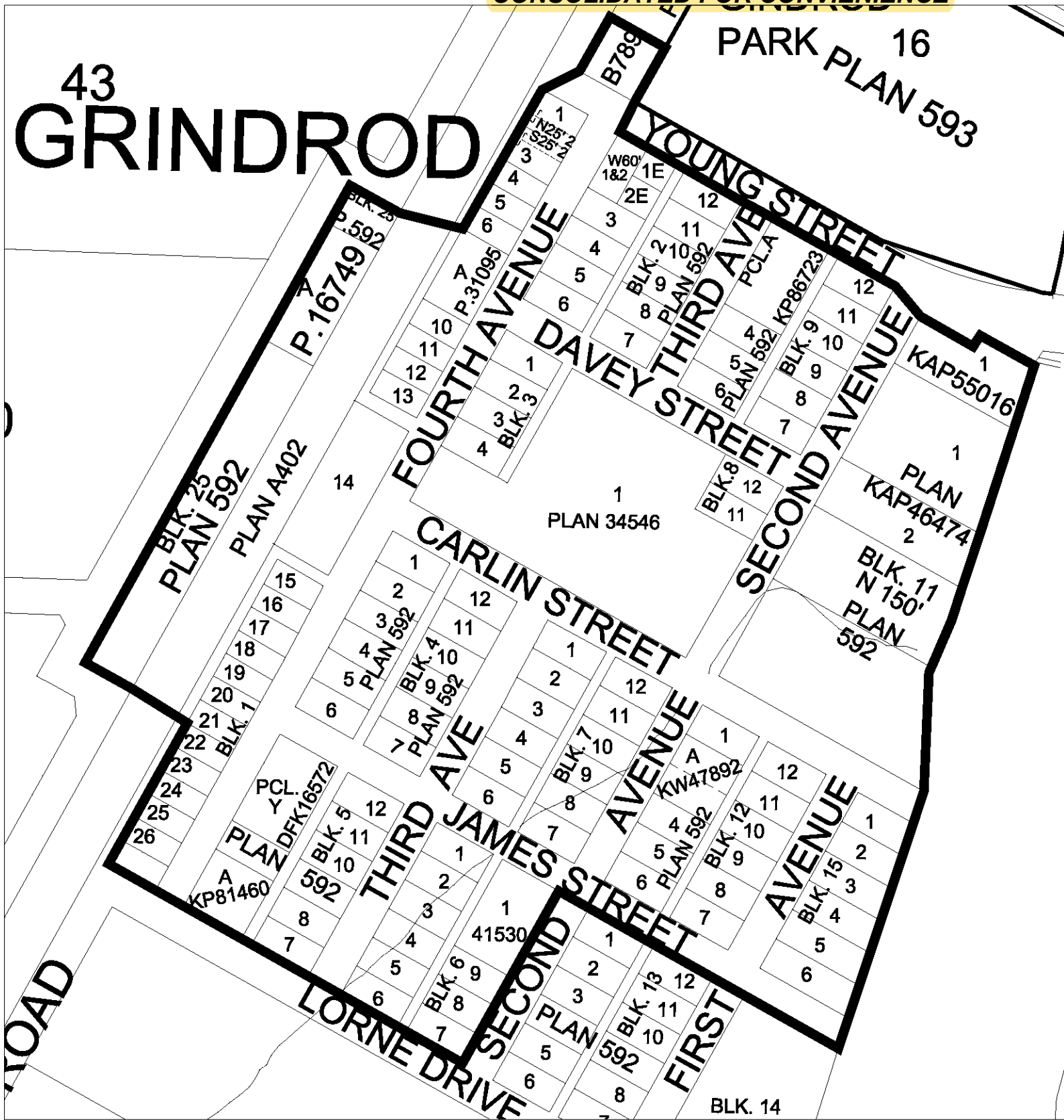

**SCHEDULE 'B' to accompany "Grindrod Street
Lighting Service Unit Amendment By-law No.
640, 1985" Specified Area.**

Consolidated for convenience only

